



Swan Family  
of Companies

# Site Lines



Valvoline— Victor , NY

## In This Issue

- President’s Message
- Employee Highlights
- LGE Project Updates
- Shop Talk— Swan ET

### Check out our websites...

- [www.lgevansinc.com](http://www.lgevansinc.com)
- [www.swanetllc.com](http://www.swanetllc.com)
- [www.swantruckingwest.com](http://www.swantruckingwest.com)

### And our social media accounts:

- <https://www.facebook.com/lgevansinc>
- <https://www.facebook.com/SwanEquipmentTruckingLLC>
- <https://linkedin.com/in/lgevans/>

Photo Credits: Dane Duffy , Ron Cartwright, Micah Lepp, Stefan Nolan

## 2023 and Beyond

I would first like to thank every employee and their families for another successful year.

I am proud of how everyone worked together this year to complete a host of projects with, what I would say, had the most challenging schedules and delays we have seen as a company. It took a huge effort from everyone to maintain the schedules, stay positive, and deliver a quality end product for our customers. We succeeded in all three areas and have surpassed our customers expectations once again. Thank you all for that.

Great things are happening in our region. We can all feel the unpredictability of the economy, but the forecast for us is strong. The Buffalo/Rochester/Syracuse corridor is very close to being designated as a “Regional Technology and Innovation Hub” by the U.S. Department of Commerce. We already have substantial projects coming to our area, but this could be a game changer and bring growth to our region like we have never seen.

Growth we are ready for! We have a solid foundation built with great people, strong leadership, and sound values. Having that foundation is what will permit our continued growth and prosperity.

Saturday, December 9th, is our annual holiday party. I look forward to seeing everyone for a night of celebration. We have a lot to celebrate, including 10 years in business!

Thank you everyone for your dedication and hard work!



# Please join us in welcoming...



## **Richard Johnson, Heavy Equipment Operator, LG Evans Construction**

Richard joined us on August 14<sup>th</sup>. Since his start date, Richard has been with Donny Trost out at the Lehigh project. Richard has 49 years of experience in heavy equipment. Being raised on a farm, he first operated a tractor at the age of 5. After years of running his own business, RJ Excavation and Contracting, Richard decided it was time to make a change. We are fortunate to have Richard.

## **Daniel George, Site Laborer, LG Evans Construction**

Daniel joined the team on May 30<sup>th</sup>. During his time here, Daniel has been working with Randy on multiple projects. Daniel previously worked on the family farm, George Farms, Almond. He performed multiple tasks within the family business. Stacking hay, milking the cows, running equipment, performing the repairs, ordering materials, paying the bills; which explains his ability to multitask while on the job. Daniel is getting married in June of 2024. Congratulations and welcome aboard.



## **Micah Lepp, Construction Layout Manager, LG Evans Construction**

Micah joined LG Evans on August 28<sup>th</sup> in the capacity of GPS and Survey. Micah has a great story. He's been almost completely self-taught. Putting himself through online training and seminars. Micah built our first in-house model for the Finger Lakes Health project which started on 10.23. Micah is married and has five children ranging from ages 10 to 4. In his spare time, Micah enjoys learning more about survey and also snowboarding. We're very happy to have Micah on the LG Evans team.

## **Amber Quill, Construction Coordinator, LG Evans Construction**

Amber joined us on October 30<sup>th</sup>. Amber will be wearing multiple hats for the team. Taking a huge workload off of Paula's plate and also working as a conduit to keep information flowing between the field and the office. We are excited for this position as its key role is to streamline communication and information. Amber is married with a 9-year-old daughter. They are expecting their second child in December. As a hobby, Amber likes to grow and cut flowers. Welcome to the team, Amber.



## **Joe Finocchario, Class A Truck Driver, Swan Equipment & Trucking**

Joe, a local family man, is married with kids and grandkids. Joe worked with Tom Turchello at Riccelli's for years. Growing up, Joe worked on the Finocchario farm. He is a hard working, work until the job is done, kind of guy. We are excited Joe has joined our team!

## **Bob Raftery, Class A Truck Driver, Swan Equipment & Trucking**

Bob has been driving truck for 28 years. He came to Swan E&T in June this year. He loves to ask people what they do here, and how they do it. Then he goes home and tells his grandkids all about it. Bob's hobbies include firearms and motorcycles. Welcome, Bob!

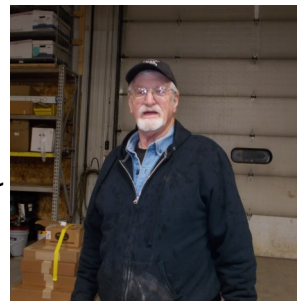

## **Emery Uveino, Class A Truck Driver, Swan Equipment & Trucking**

Emery is a family man as he is married with 2 children. When not working Emery enjoys draft horses and wrestling. Emery's experience you ask, only 37 years. Glad to have you on our team!

# Starbucks—Latta Rd, Greece

By Don Lewis

This project was for a new general contractor customer, Vasile Construction, and his client who develop quite a bit of commercial sites in the Greater Rochester area. The scope of work on the 1-acre parcel included the complete site construction for the Starbucks Coffee Café with a large drive thru area and decorative masonry screen wall along Latta Road. The site utilities include the extension of the Town's sanitary main to service the site as well as a watermain connection in the Latta Road right-of-way. The project triggered the requirement for a lane widening of the Latta Road Pavement to accommodate the extension of a left turn lane.



This work was a large addition to the project scope on one of the busiest NYSDOT roads in Monroe County. Our crew and subcontractors collaborated to tackle this extra work head on and maintained an efficient schedule to complete the work in a timely manner. There were struggles with the local neighbors and inspectors and our crews should be commended for their efforts to solve issues on the fly as well as maintain a good image for LG Evans.



The NYSDOT Permit included the removal and replacement of 1,300 lf of curbing on both sides of the road as well as creating a 6,300-sf drive lane. The curb line catch basins needed to be extended to the new curb and 4,000 sf of concrete sidewalks were relocated. Again, our crews worked well with the NYSDOT inspector, developer, and Town of Greece to resolve the lack of plan design information and provide a great product.

LG Evans had a lot of exposure both visually and safety wise and we really came out on top. The developer and owner have been very appreciative of the efficiency and quality of our work. We are pricing more work for this same GC and the future looks bright for a successful relationship. We can be proud of how we pulled together.



# Bank of America, Hudson Ave, City of Rochester

By Don Lewis

The Bank of America job is located along Hudson Avenue in the northeast corner of the City of Rochester just south of Ridge Road in Irondequoit. This project was for another new general contractor, Vericon. They are becoming more present in the Western New York area with their main office in New Jersey. The bank site parcel was carved out of an existing Walmart parking lot that was largely void of use. It featured a new bank building with drive thru and associated parking, curb, sidewalks, and utilities.

The project was slated to begin last fall, but the new building did not have access to municipal water or sanitary sewers. To allow issuance of the building permit, the owner was required to design, obtain approvals, and pay for the extension of the water and sanitary mains to front the new building. The soils within the building footprint required a substantial undercut and import to allow a good foundation for the building trades to start.

The existing mains were terminated in the entrance of the Walmart Plaza on Hudson Avenue and 245 lf of new 8" sanitary main/manholes and 200 lf of 8" watermain with a new hydrant were required. The location of the work posed an issue with the City's Traffic Control Board and took more than 6 months to iron out a plan to perform the utility installation work during low peak traffic hours from 8 pm to 6am. Unfortunately for the owner, this greatly increased the costs due to the lack of availability of some materials after hours, multiple lane closures set-ups and tack downs, and labor.

With the utility installations happening overnight, the City of Rochester required us to plate the work completed for the shift and return during the off-peak traffic hours from 9 am to 3 pm to remove the plates to allow our paver to install hot mix asphalt. The asphalt suppliers do not offer materials at night for jobs this small.

Again, our crews stepped up to spearhead the demanding work hours as well as challenges with field conditions, delays, inspectors, and ever-present safety concerns with working in a busy right-of-way. This right-of-way work was almost coinciding with the NYSDOT work happening at the Starbucks project in Greece and many employees worked both jobs.

Again, I need to commend our crews for putting their best feet forward to represent LG Evans, work together, handle the ever-changing conditions and design, maintain a safe working environment, and produce an attractive, well-constructed project. This project saw many different site foremen and the job schedule allowed us to insert and relocate crews to accommodate our other jobs. The client again is singing our praises for a job well done and our efforts to keep the job on schedule.



# Lehigh Ridge Subdivision, Henrietta

By Matt Cobb

LG Evans has teamed up with Lehrwood Estates LLC, a division of Howlett Farms in Avon, NY, to provide grading, stormwater management, utility mains, and lateral services for what will eventually be a 110– lot single home division.

Lehigh Ridge is 65 acre property cornered between E. Henrietta Rd and I-90. Before LG Evans began, it was an unfinished & abandoned golf course. Challenges include performing our work around two 24” gas transmission lines as well as under two high voltage power lines & associated transformer towers.

Howlett Farms is an exciting client to become associated with as they move into even more residential housing development. We are excited to be a part of this project and hopefully it leads into a lasting relationship with their team.

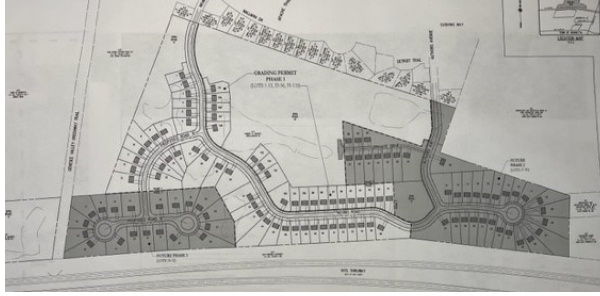

## Orafol Precision Addition

The Nichols Construction Team is working with our concrete division on a 2500 sq ft foundation addition to an existing manufacturing company, located at 200 Park Centre Drive in West Henrietta.

This project will take approximately 74 days to complete.



Watch for NEW upcoming jobs; Finger Lakes Health Surgery Center, Pines of Perinton, and RHA Parliament Arms– Fairfield Village.

# Shop Talk with Jay Helker

It's that time of year again—the temperatures are dropping and the leaves are changing. Both the equipment and our bodies take a little more effort to get going for the day. Keep that in mind when looking over your machines and trucks ensuring we are giving ample warm up time and pre-trip inspections before hitting that throttle.



With the cooler weather, there are a few things to consider with both the heavy commercial trucks and construction equipment:

- ◆ Drain air tanks daily, this prevents freeze up issues and premature air system component failures.
- ◆ Ensure all fluids levels are at appropriate levels, the cold causes additional strain on everything low fluids levels will only cause additional system efforts.
- ◆ Keeping operators stations clean-this is not only for cleanliness and overall safety but helps the heating system operate to its full potential.
- ◆ Allowing machines warm up time, machines should be allowed the build oil pressure and warm while conducting pretrip inspections. This is upon startup to allow the engine to acclimate with the ambient temperature. Both trucks and equipment need not idle when not in use otherwise.

Recently added equipment this season includes:

- ◆ LG707 2020 Hyundai HL940 Loader
- ◆ LG708 2023 Hyundai HL940 Loader
- ◆ LG213 2023 Link Belt 145
- ◆ LG 214 Yanmar SV100 (Rubber track machine)

Jeff and Michael put a lot of effort into research and operator feedback to make this decision. As we grow, input from all of you remains crucial in assisting in the best choices as we drive on. These machines are an investment, please keep that in mind when operating them ensuring we are taking care of them properly.

I am especially proud of the group we have going into the fall, we have worked hard this season and have overcome challenges as they are thrown at us. We are working with a crew that is seasoned, well trained, and respectful of each other. This isn't by mistake; We are setting the standard and working together to elevate each other. Your roles are all reflective of this in the shop, in the trucks, and in the front office. We all have grown, working and driving to improve ourselves. Keep up the good work as we head into the holiday season!



*"Opportunities come infrequently. When it rains gold, put out the bucket, not the thimble." ~ WB*

If there is one thing for certain, Swan Companies will invest back into the business whenever opportunities arise. This year, LG Evans was able to seize that opportunity and add four equipment pieces to the heavy duty fleet.

Both Hyundai loaders are larger than the 740 series we have in the fleet now. This will provide more muscle on the larger jobs with higher horsepower and hauling capacities. There is a side dump bucket as well to aid with pipe crew operations.

Both excavators are new manufactures for our fleet by design. So far, we have received much positive feedback from the crew that they are great additions to the fleet!



2020 Hyundai L940 Loader

2023 Hyundai HL940 Loader



2023 Link Belt 145x4



2023 Yanmar SV100

## Congratulations to our 5-year employee work anniversaries!

*Matt Cobb*

*Michael Hill*

*Doug Nothnagle*

*Don Lewis*

*Randy Ralyea*

*Ryan Ralyea*

*Jared Swift*



## Save the Date:

### Swan Companies Christmas Party:

*Saturday, December 9th at The Avon Inn, 5:00 pm*

### Upcoming Holidays:

*Thanksgiving, Thursday 11/23*

*Day After Thanksgiving, Friday 11/24 (Floater)*

*Christmas Day, Monday 12/25*

*Day After Christmas, Tuesday 12/26 (Floater)*

## Fundraising Opportunities:

Once again, this holiday season we are participating in the Adopt-A-Family program in partnership with Catholic Charities of Livingston County. This year our family includes a 2 year old girl and 6 year old boy.

We are also taking donations for **Chances and Changes** (Victims of domestic violence) in Livingston County. Donations include non-perishable food, clothing, and personal care needs.

Gift Cards are always welcome for either fundraiser!

We will be taking donations at the main office starting Monday November 13<sup>th</sup> through Wednesday December 13<sup>th</sup>. Contact Tina for further details.

